

AML PS4750 Covered Hopper CamPac Box™ Quick Install Guide

Ted Doskaris, 9/21/2020



Trucks are to be temporarily removed and then have their factory coupler tang removed. This is required for rotational clearance once trucks are reinstalled following the installation of CamPac parts.



With small foot print, direct fit body mount CamPac Boxes™ installed, car operation can be down to 8 foot diameter track curves without wheels rubbing.

CamPac Box Preparation

Obtain Kadee* 907 kit and install parts as illustrated.

Mounting Screws:

Provided are screws to body mount the boxes on the chassis pads. These are # 2 -56 machine screws having two different lengths shown in the illustration.

In the event the car had been fitted with a larger #4 self-threading screw at the pad's tail hole/s, a longer #2-56 screw with a nut can be substituted.

Machine type screws are used for fasteners

AML PS4750 Covered Hopper Car CamPac Box™ fitted with centerset coupler, lid & springs from Kadee 907 kit

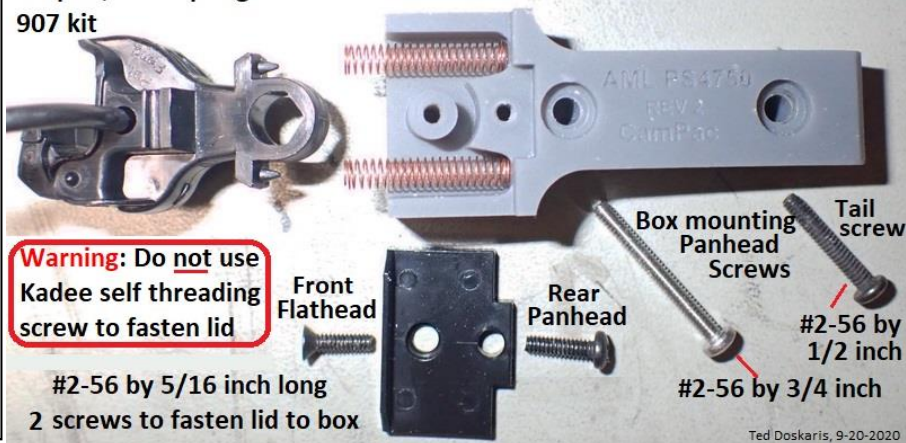

Advisory: Owing to an apparent factory design deficiency, this car is susceptible of having its chassis / body separating under the bolster area where trucks mount. The CamPac "S Clip", when installed, will aid in preventing this. Accordingly, if the car exhibits this condition, the areas of separation should be re-glued.

*Kadee is a registered trademark of Kadee Quality Products Co., White City, Oregon, USA.

A new hole is to be located on the mounting pad as shown. The CamPac Box™ can be used as a template to do this.

CamPac Box™ as template for locating front hole

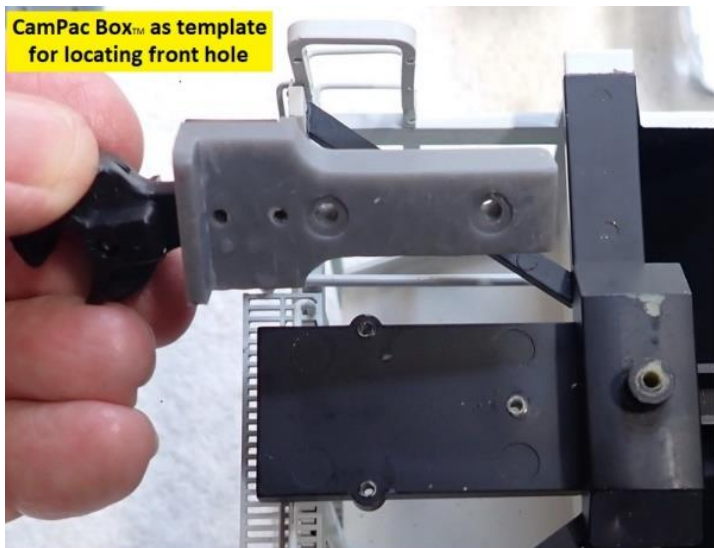

Center align & seat box on pad, then insert screw into rear hole, then thread screw in pad hole & tighten

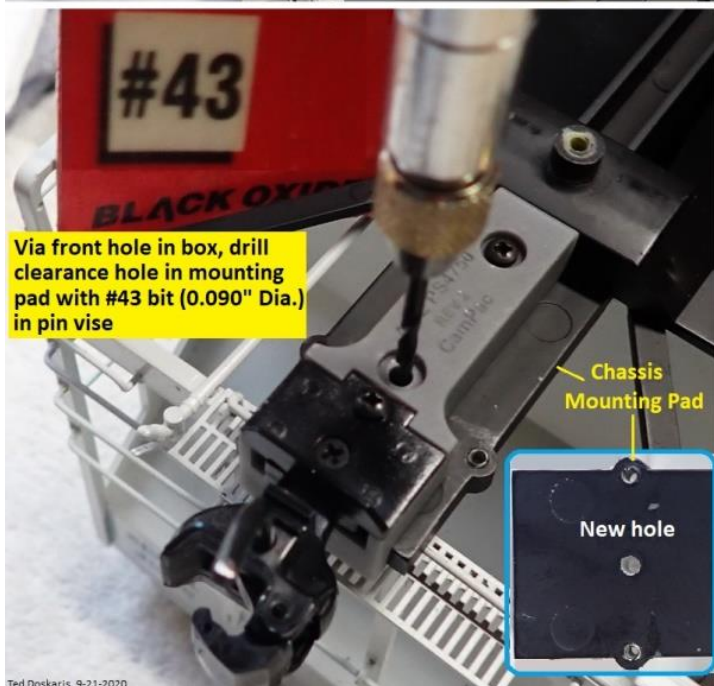

Via front hole in box, drill clearance hole in mounting pad with #43 bit (0.090" Dia.) in pin vise

Chassis Mounting Pad

New hole

Ted Doskaris, 9-21-2020

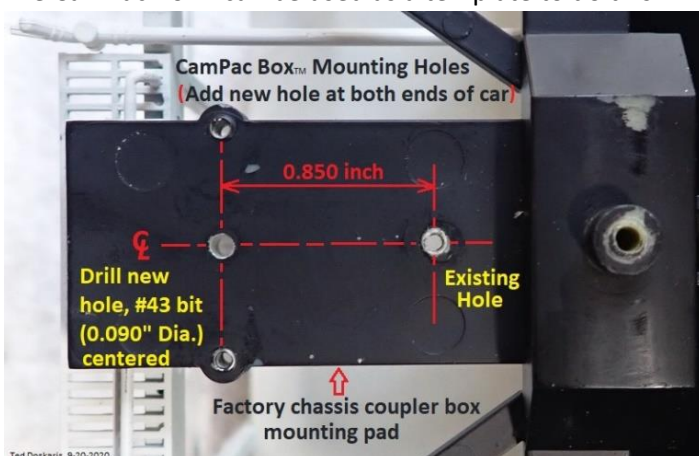

Install CamPac Box™ and "S Clip" - method shown below:

With thumb at box front and finger on "S clip", pinch/manipulate so clip hole aligns with box hole & thread in screw

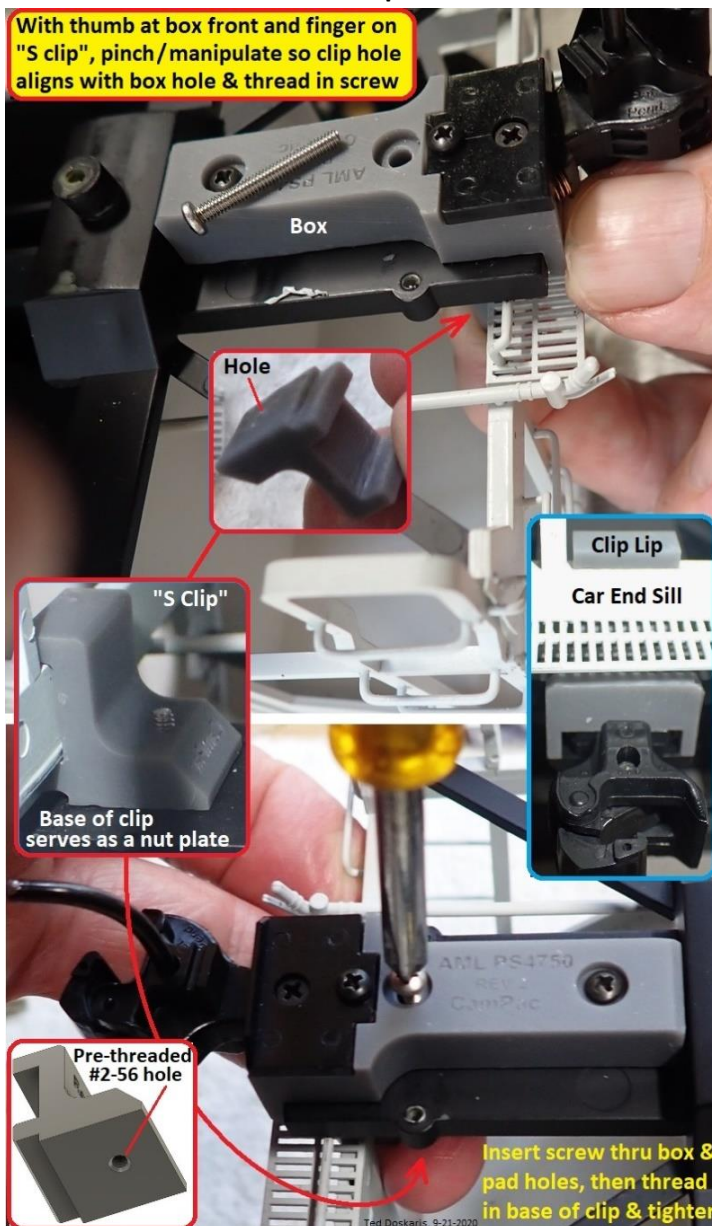

Insert screw thru box & pad holes, then thread in base of clip & tighten

Ted Doskaris, 9-21-2020