

# AML Bethgon Car CamPac Box™ Quick Install Guide

Ted Doskaris, 8-28-2020

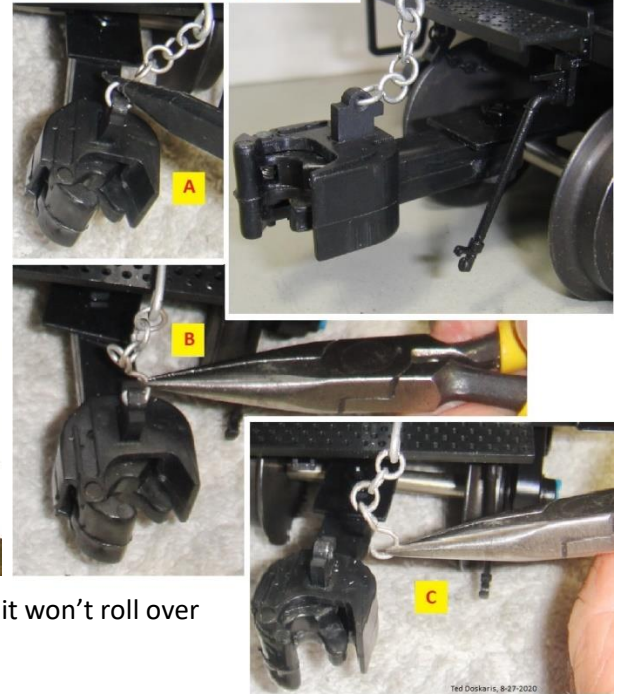

Remove cut lever chain from coupler pin  
Example done by poking thru link to spread it apart and then withdrawing it with pliers



When working on the car with it placed upside-down, it's behooving to first remove its coal load so it won't roll over

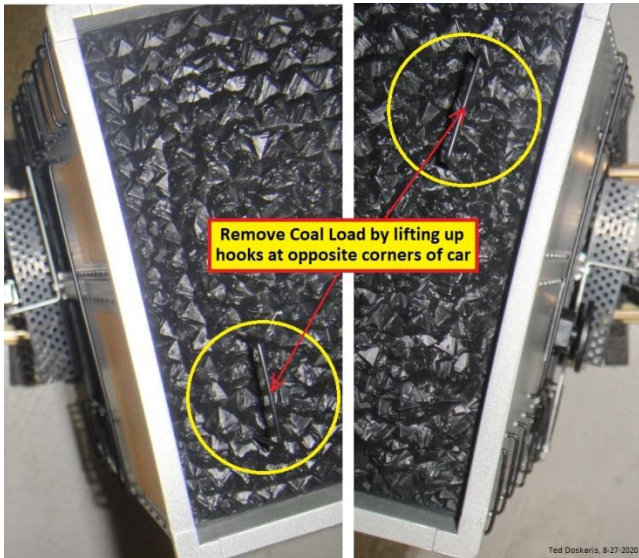

Remove trucks from car and then couplers with brackets from trucks



**CamPac Box Preparation:** Obtain Kadee 907 kit & install parts - illustrated below

AML Bethgon Car CamPac Box™ fitted with centerset coupler, lid and springs from Kadee® 907 kit



**Warning:** Do not use Kadee self threading screw to fasten lid which can cause a damaged box

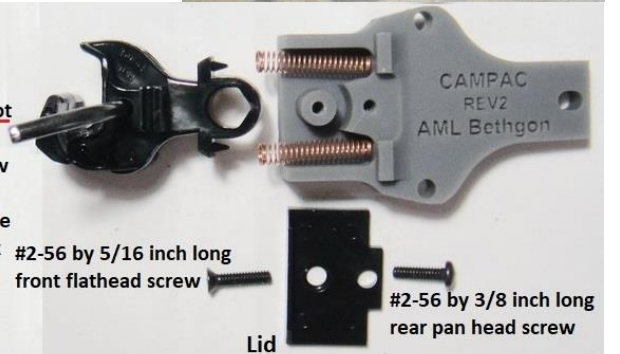

\*Kadee is a registered trademark of Kadee Quality Products Co., White City, Oregon, USA.

Ted Doskaris, 8-27-2020



## Mount the CamPac™ Boxes

Three screws are used to body mount each box on the chassis. They include choices of AML factory self-threading screws from the AML coupler box kit supplied with car or #2-56 by 7/16" machine screws that can be provided with CamPac parts.

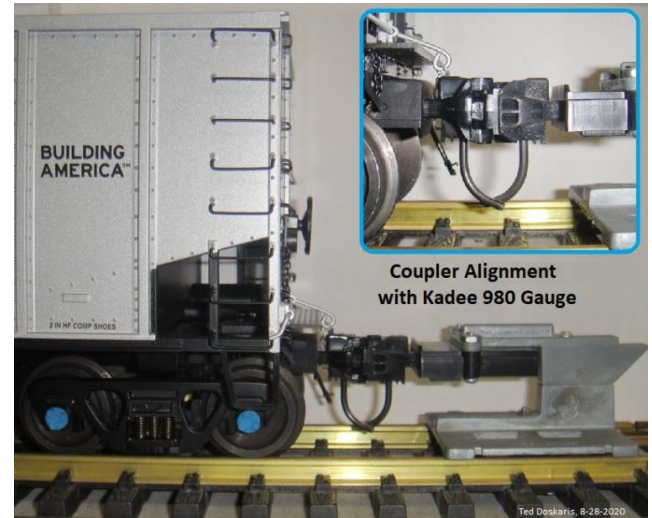
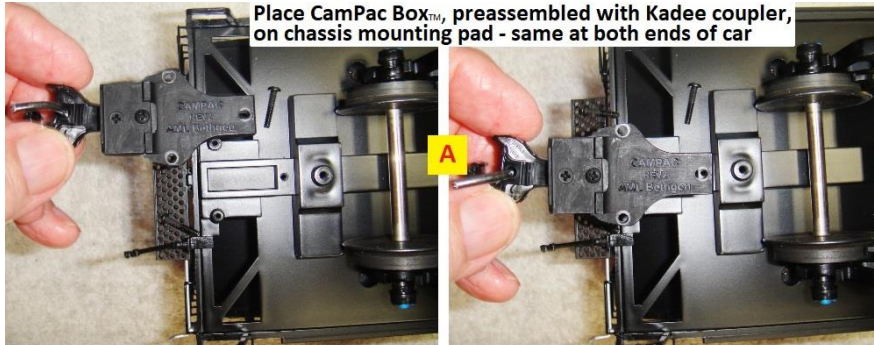

Coupler should align with the Kadee coupler height gauge. If not, the box can be shimmed to align with the gauge - example methods shown below.

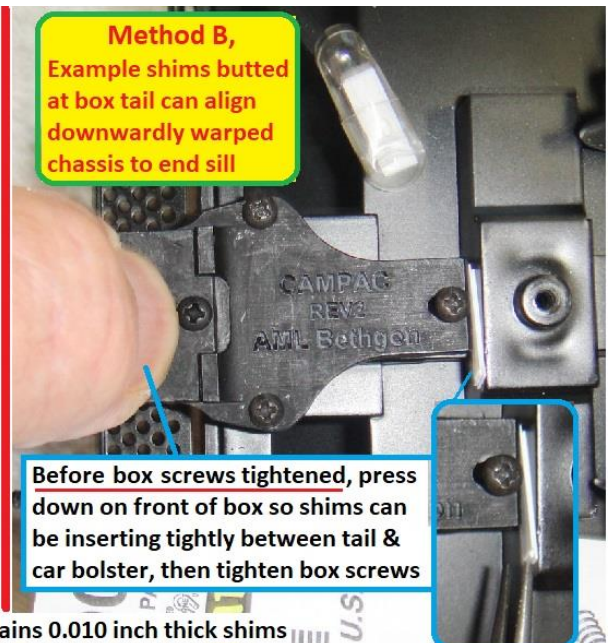
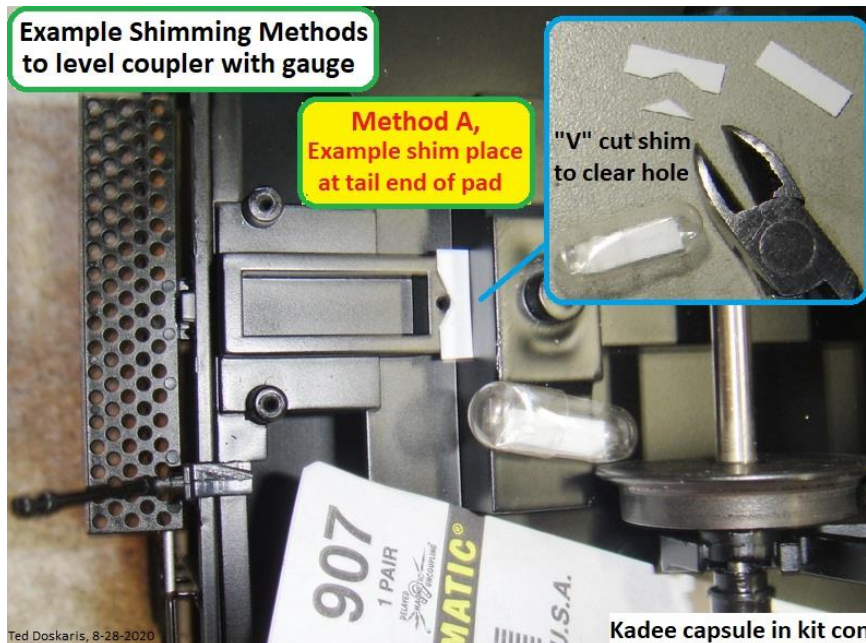

**Note:** If coupler alignment with gauge is too high, the box may need to be shimmed under its front or overall entirety.